



INSTRUCTIONS WARRANTY  
CARD

---

**H IG 700**





# **INSTRUCTIONS FOR USE OF THE POWER PACK:**

## **Home**

Thank you for your trust and congratulations on making the right choice.

The power plant you have purchased has:

- a modern, four-stroke, fuel-efficient petrol engine,
- robust, aesthetic construction.

The power unit has been designed and manufactured in accordance with the safety regulations of the European Union. Use it in accordance with its intended use, following the instructions in the operating manual. Please familiarise yourself with the contents of this manual. In case of any doubts, please contact Hahn & Sohn GmbH or its Authorized Regional Representative before putting the equipment into operation.

Please also read the Warranty Card. The Warranty Card describes the basic user obligations, which, if followed, will ensure the good condition of the equipment and protect against loss of warranty. If the user does not comply with the instructions in this manual, Hahn & Sohn GmbH will not be liable (under warranty) for any resulting damage. In this case, Hahn & Sohn GmbH is also not liable for injury or death to the operator or other persons.

There are a number of warnings, e.g. in the form of warning labels, both in the instructions and on the device. Ignoring these warnings can cause a serious accident.

The manual contains information current as of the date of printing. It may vary slightly from the appearance of the device and its parameters due to the continuous development of the product and the introduction of improvements. The user is obliged to draw attention to these differences.

This manual must be attached to the power pack and sold with it.

## **INITIAL GUIDE**

revision 1.0  
dated 7.02.2022

# CONTENTS

Home.....	1
1. Safety instructions.....	5
2. Construction of the aggregate.....	7
3. Before commissioning.....	12
4. Functions of the power plant.....	12
5. Service.....	16
6. Storage.....	22
7. Troubleshooting.....	23
8. Technical data.....	25
9. Electrical diagram.....	26
10. Declaration of conformity.....	27
Warranty Card.....	28

# 1. Safety instructions



It is to read the operating instructions before putting the power pack into operation for the first time!

1. Only persons of legal age may operate the equipment.
2. When working with the equipment, it is necessary to follow the instructions in the operating instructions and the applicable OSHA, PO and state regulations.
3. In case of any doubts related to the operation and/or commissioning of the power unit, please contact an Authorized Representative of Hahn & Sohn GmbH.
4. Place the power pack a stable, level surface.
5. The work area must be tidy and properly lit. A powder extinguisher and emergency lighting must always be available near the power station.
6. Store the power pack in a dry, well-ventilated place. Do not breathe in the exhaust fumes produced during operation - poisoning can be fatal.
7. Working equipment must not be left unattended and unauthorised persons must not be in the vicinity.
8. Do not operate the equipment near explosives, flammables, gases, dust, open flames. It is forbidden to store fuel tanks near the power plant. In the event of a fuel leak, shut down the power unit immediately and take it to an authorized service center for repair.
9. The device must be located at least 1 m away from walls and other equipment.
10. Do not touch rotating elements while the machine is in operation.
11. Using the power tool in high humidity conditions, near water tanks or sprinklers, and operating the power tool with wet hands can cause electric shock.
12. If the generator is to be connected to the building's emergency power supply, the wiring must be carried out by a person with the appropriate electrical certificate.

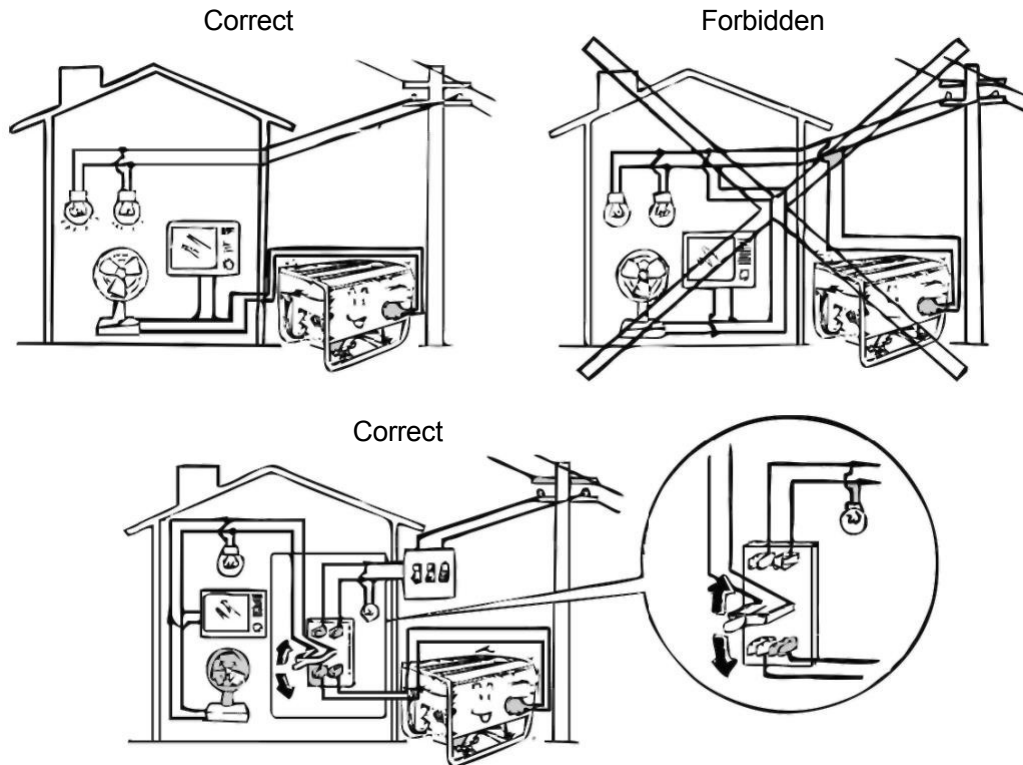

14. Keep the power unit out of the reach of children, animals and unauthorised persons.
15. If the power pack is stored outdoors, check the condition of the equipment before each use. Dirt and ice can cause malfunctions in the power unit, short circuits in the electrical components and, as a result, electric shock.
16. Refuelling with the device switched on is strictly prohibited.  
Stop the equipment before refuelling.
17. Do not operate the power unit in the event of a fuel spillage. Remove the spilled fuel and wipe the splashed area dry.
18. Do not smoke or use open flames near tanks.
19. Do not place any objects on the working equipment.
20. During operation, some elements of the device (exhaust, muffler, engine) heat up to high temperatures. Do not touch hot elements while the power unit is running or immediately after it has stopped.
21. Do not overload the power pack, overloading can cause damage

## 2. Construction of the power plant

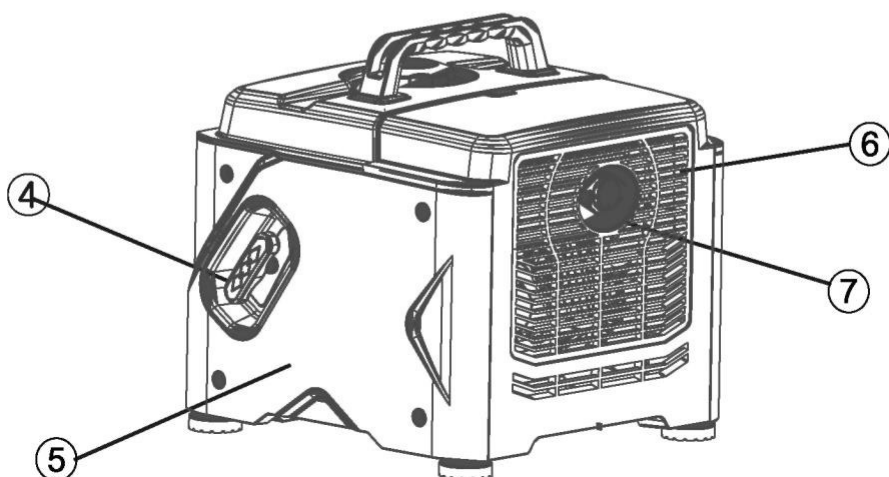
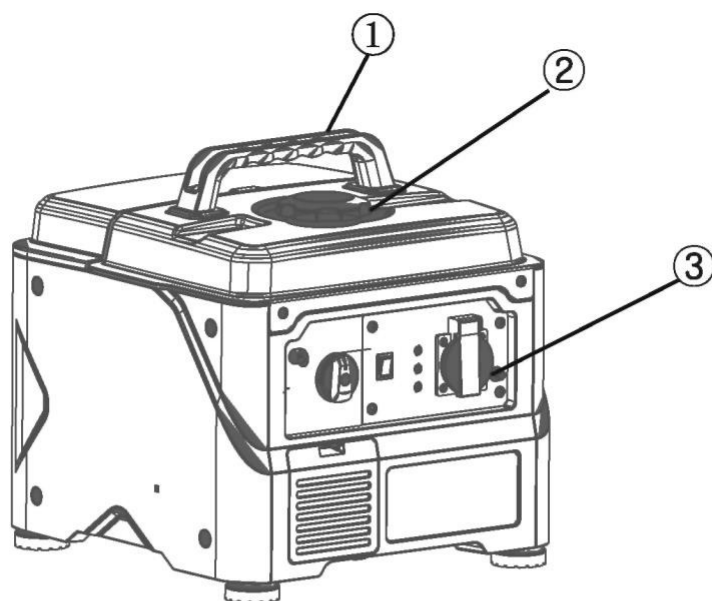

- 1 - Handle
- 2 - Filler neck stopper
- 3 - Control panel
- 4 - Handle for manual starter
- 5 - Side cover
- 6 - Rear cover
- 7 - Silencer

## 2.1 Control panel layout

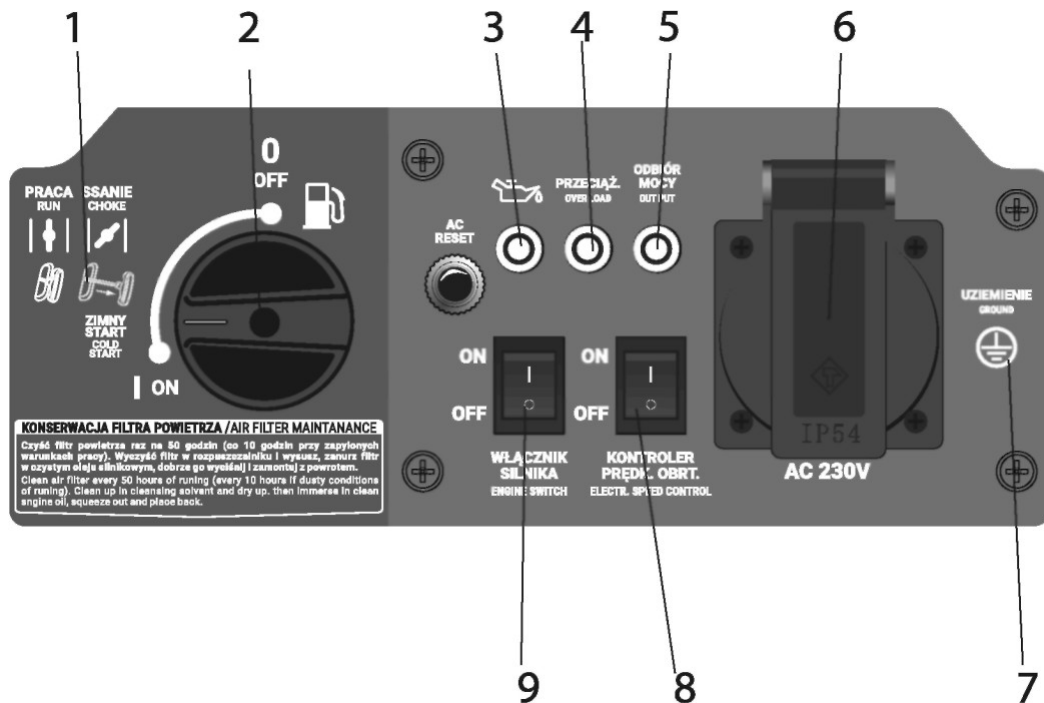

- 1 - Choke lever
- 2 - Fuel tap actuator
- 3 - Low oil level light
- 4 - Power pack overload light
- 5 - AC indicator light
- 6 - AC socket
- 7 - Grounding clamp
- 8 - SMART switch
- 9 - Engine switch



## 2.2 Check

### 2.2.1 Fuel tap actuator

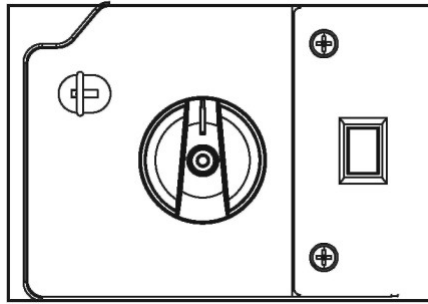

If the fuel tap control is in the ON position, engine can be started.

If the fuel tap control is in the OFF position, engine cannot be started.

### 2.2.2 Oil warning light

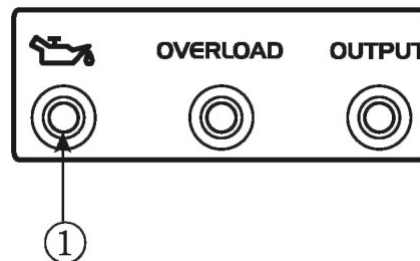

If the low oil light is , the engine will stop automatically. The engine cannot be started until the oil is topped up.

TIP: If the engine has stalled or cannot be started, turn the fuel tap control to the ON position and pull the hand starter handle. If the indicator light is flashing, it means the oil level is insufficient, oil needs to be topped off.

### 2.2.3 Power pack overload light

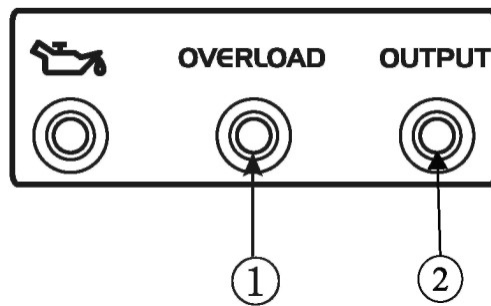

The overload indicator light (1) will illuminate if an overload occurs and the inverter unit overheats or the voltage at the AC outputs increases. The circuit fuse will then activate, interrupting current production (motor continues to run, AC indicator light (2) will go out, overload indicator light (1) - red will be on).

Procedure:

1. Switch off all appliances and stop the engine.
2. Reduce the load on appliances.
3. Check air inlet clearance.
4. Start the engine again.

TIP: The overload indicator light may illuminate for a few seconds after connecting a device has a higher starting current. This situation is not a malfunction, but may cause damage to the inverter.

### 2.2.4 AC indicator light (green)

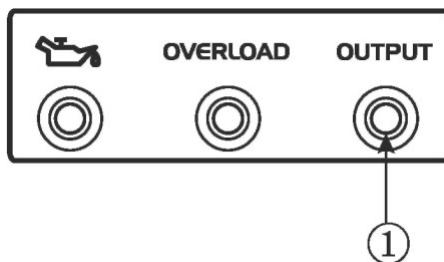

The light will come on when the engine starts if the voltage parameters are correct.



Reduce the load on appliances below the rated output of the generator when the AC protection trips. If the fuse trips repeatedly, stop the equipment immediately and contact authorized service.

### 2.2.5 Earthing

Connect the ground to terminal (1) on the power pack.

Always ground the power pack before working.

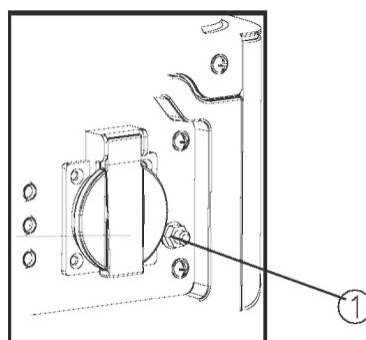

### 2.2.6 Filler neck stopper

Unscrew the stopper by turning counterclockwise to vent the tank while working.



The tank must be vented during operation.

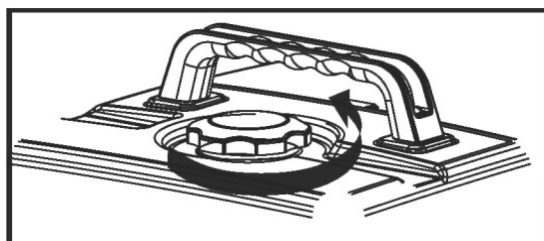

### 3. Before commissioning

#### 3.1 Checking the fuel level



Gasoline is flammable and toxic. Refuel only in a well-ventilated area with the engine stopped. Do not use fire near petrol.



Be careful not to fill too much fuel - the fuel must not be all the way to the tank filler neck. Tighten the fuel filler plug and wipe up any fuel spillage.



Store petrol out of reach of children and animals.

The recommended fuel is unleaded petrol Pb95/E5. If the fuel level is low, top up to the upper level. Do not use any additives. Do not mix petrol with engine oil or diesel fuel. Avoid all contamination of the fuel, especially water and sand.

The fuel tank has a capacity of 2.8 litres.

#### 3.2 Checking the oil level

Using poor quality or worn oil can shorten the life of the equipment. Using equipment with insufficient oil can cause serious damage to the equipment.

Recommended oil: SAE 15W-40 Oil  
tank capacity: 0.28 litres

Stop the engine, wait for the engine to cool down and place the machine on a level surface before adding oil.



Change the oil regularly

For oil changes:

1. Unscrew the covers (1) and remove the cover (2).
2. Unscrew the oil filler plug (3).
3. Top up with the correct oil.
4. Screw in the plug and reinstall the cover.

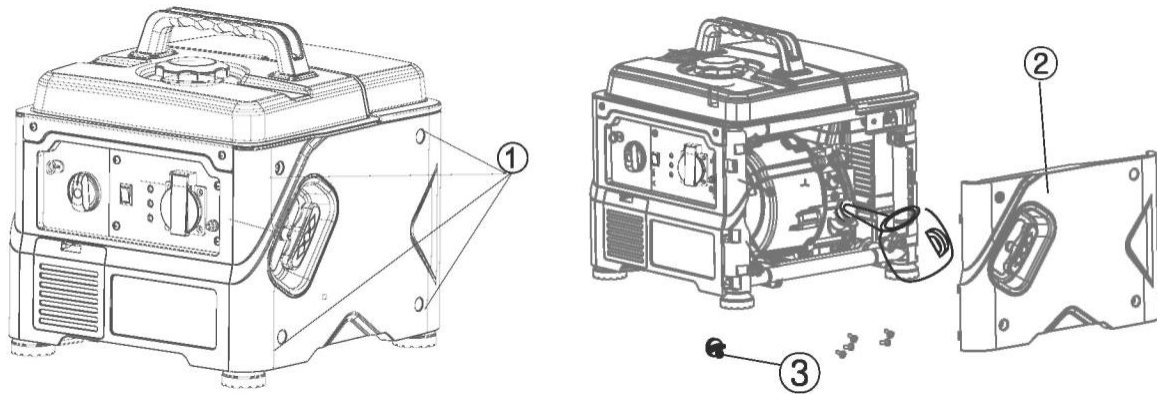

If any element of the equipment is not working , it must be repaired before it can be put operation.

#### 4. Functions of power station



Do not connect appliances to it before starting the engine. Remember to top up the fuel and engine oil and check the the condition of the equipment.



The power unit can be used with rated load in normal climatic conditions: ambient temperature 25°C, barometric pressure 100 kPa, relative humidity 30%. The power output of the power unit varies according to temperature, altitude (lower air pressure at higher altitudes) and humidity. The power output of the power plant decreases if the temperature, humidity and altitude are higher than for normal climatic conditions. Never use the power pack in enclosed rooms.

#### 4.1 Commissioning the power plant

1. Switch the engine on switch to the "ON" position
2. Pull out the choke lever.
3. Turn the fuel tap control to the "ON" position.
4. Switch the SMART switch to "OFF".
5. Pull the hand starter handle vigorously.
6. Wait a few minutes before connecting appliances.
7. Switch on the SMART switch

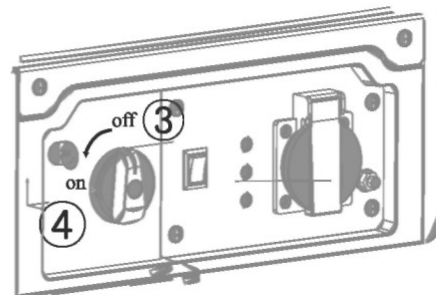
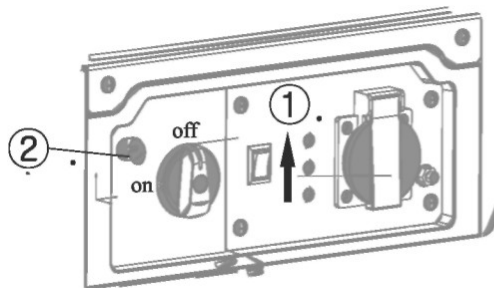

#### 4.2 Switching off the power unit

1. Disconnect all appliances from the power supply.
2. Switch the engine switch to the "OFF" position
3. Turn the fuel tap control to the "OFF" position

#### 4.3 Connecting appliances to AC (alternating current) sockets



Before connecting electrical devices to AC outlets, make sure they are switched off.



Make that all connected electrical equipment, including wires and plugs, are in good condition.



Make that the total load is less than the rated capacity of the power pack.



Make the load current is less than the rated current of the socket.



Make sure the power pack is earthed. If the electrical equipment is not earthed, the power pack must always be earthed.

1. Start the engine
2. Connect the device to an AC power outlet
3. Make the AC indicator light is on
4. Switch on the appliances



Remember to switch on devices with a high starting current first.



Most motor-driven equipment has higher than rated electrical parameters during start-up. If the red overload light does not go out after this time, contact Hahn & Sohn GmbH or your Authorised Regional Representative.

When connecting several electrical appliances, connect the appliance with the highest starting current first and the appliance with the lowest starting current last.

If the power pack is overloaded or there is a short circuit in the connected equipment, the red overload light will come on. After approximately 4 seconds, the power to the connected devices will be disconnected and the green AC light will go out. Stop the device and determine the cause of the problem. Determine if the cause is a short circuit in the connected equipment or an overload, repair and return the equipment to service.

#### 4.3 Application

The following table shows the performance of the device when used alone.

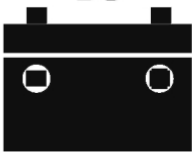
AC				DC 
Effector	1	0.8 - 0.95	0.4 - 0.75 (efficiency 0.85)	
1 kW	< 3000W	< 2400W	< 1200W	Rated voltage 12 V Rated current 8 A

## 5. Service

The following table (on the next ) lists the mandatory checks and inspections of the power pack. Compliance with these recommendations will extend the life of the equipment and protect against loss of warranty. Failure to follow the recommendations in the table may result in loss of warranty.



If the power unit is frequently operated under high loads or at high temperatures, an oil change is recommended every 25 hours of operation.



If the engine frequently operates in dirty, dusty or aggressive environments, it is recommended to clean the filter every 25 hours of operation.



Perform servicing according to the operating time or the engine hour meter, whichever comes first.



If you miss a service, do it as soon as possible.



Stop the engine before starting any servicing work. Place the machine on a level surface and remove the spark plug to prevent the machine from starting.



Always carry out service work in a well-ventilated area.



		Interval	First month or 20 mth	Every months 100 mth six or	Every twelve months or 300 mth
Engine oil	Control - completion	X			
	Replacement		X	X	
Gear oil (if any)	Level control	X			
	Replacement		X	X	
Fuel filter elements	Check	X			
	Cleaning		X		
	Replacement			X	
Drainage container	Cleaning				X
Spark plug	Check - adjustment				X
	Replacement	Once a year or every 250 mth			
Spark Catcher	Cleaning			X	
	Inspection - adjustment				X
Valve clearances	Inspection - adjustment				X
Fuel tank and fuel filter	Cleaning				X
Fuel lines	Cleaning	Every two years (replace if necessary)			
Engine head and piston	Cleaning *	Engine capacity less than 225 cm 3 - every 250 mth Engine capacity greater than 225 cm 3 - every 125 mth			
* these items must be repaired by an authorized dealer unless the owner has the appropriate tools					

## 5.1 Checking the spark plugs

Spark plugs are an important part of the engine and should be checked regularly.

1. Remove the cover (1)
2. Remove the ignition cable end with a tool (2)

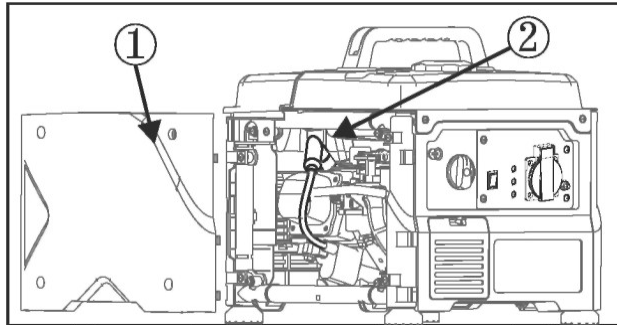

3. Remove the spark plug using the spark plug wrench (4).

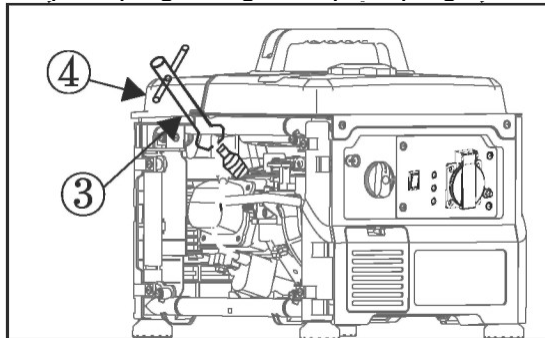

4. Check the carbonisation status of the spark plug. If carbon is visible, clean the spark plug.

5. Check the electrode spacing using a pair gauge.

The distance should be

**approx. 0.6 - 0.8 mm.**

6. Screw in the spark plug, fit the cable end and the cover.

Spark plug torque is 12.5 Nm

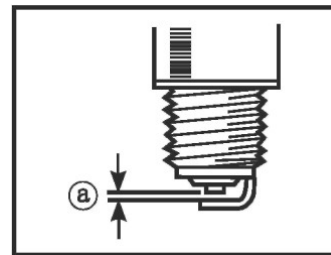

Type of spark plugs: A5RTC

## 5.2 Carburettor adjustment

Carburettor adjustment should be carried out by an authorised dealer or other professional service.

## 5.3 Changing the engine oil (see also 3.2)

Do not change the oil immediately after stopping the engine. The oil is hot and can cause burns.

1. Place the power pack on a level surface and turn the fuel tap control to the "OFF" position.
2. Remove the screws and cover.
3. Remove the filler plug
4. Place the container for the used oil under the engine. Tilt the power pack and drain all the oil.
5. Fill the power pack with new oil.



Remember to top up the oil on a flat surface. Do not tilt the power pack while refilling the oil.

6. Wipe up any spilled oil.
7. Fit the oil filler plug.
8. Replace the cover and screw in the screws.

**Recommended oil: SAE 15W-40 Oil**  
**tank capacity: 0.28 litres**

## 5.4 Silencer panel and spark arrestor

Do not touch the silencer immediately after stopping the engine, as it heats up and can cause burns.

1. Unscrew the screws (1) and remove the shock absorber cover (2).
2. Loosen the screws (3) and remove the muffler sleeve (4), muffler panel (5) and spark arrestor.
3. Remove the carbon from the muffler panel and spark arrestor with a wire brush. If damaged, replace them.

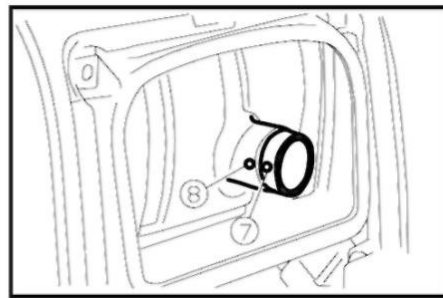
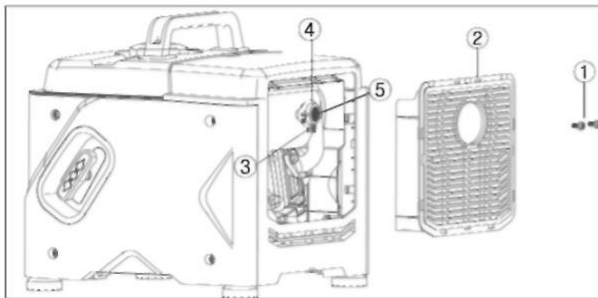

Use a soft wire brush to prevent damage to the spark arrestor and muffler panel

4. Place the spark arrestor (7) in the muffler hole (8).
5. Reinstall the spark arrestor, muffler panel, muffler sleeve and engine cover.

## 5.5 Air filter

1. Remove the air filter cover
2. Dismantle the foam
3. Wash the air filter
4. Moisten with oil and squeeze out the excess. The filter must be moistened, not wet.  
Do not wring the foam to avoid damaging it.
5. Reinstall the air filter and covers

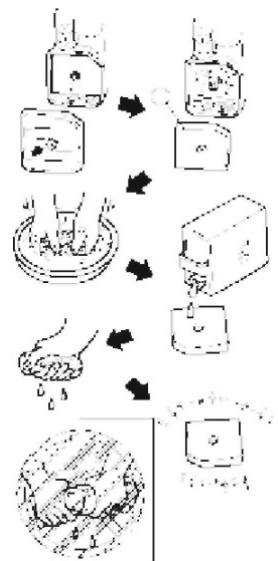
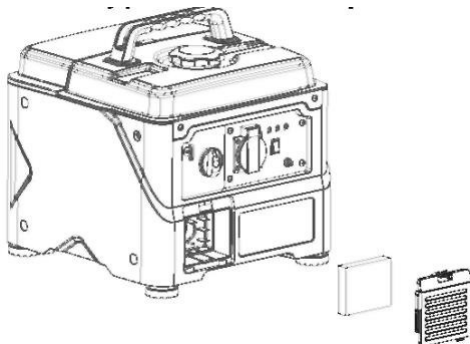

## 5.6 Fuel filler neck filter



Never use fuel near sources of fire.

1. Unscrew the fuel filler plug and remove the filter.
2. Clean the filter in petrol.
3. Wipe the filter and put it back on.
4. Screw in the filler neck plug.

## 5.7 Fuel filter

1. Unscrew the covers (1) and remove the cover.
2. Pull the cover up and pull the hose out of the tank.
3. Remove the fuel filter.
4. Clean the fuel filter in petrol.
5. Dry the filter and place it back in the tank.
6. Install the hose and brackets. Open the fuel tap to check for leaks.
7. Replace the cover and tighten the screws

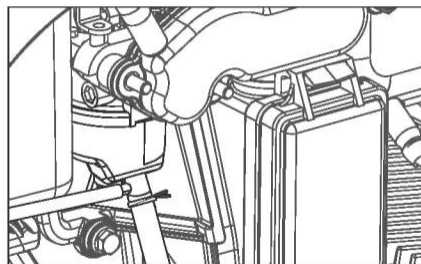
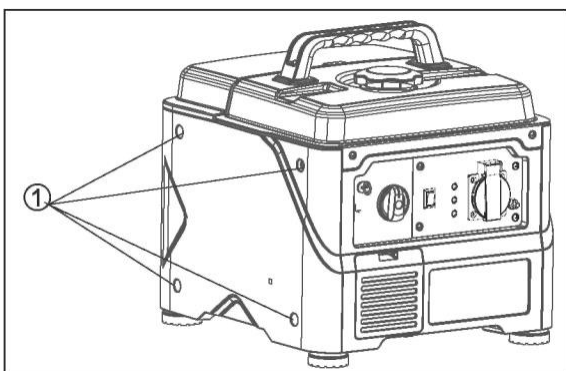

Make sure the fuel tap control is in the "OFF" position before cleaning or replacing the fuel filter.

## 6. Storage

Long-term storage of equipment requires measures to prevent damage to the power pack.

### 6.1 Fuel discharge

1. Stop the engine.
2. Unscrew the fuel filler plug and remove the filter. Drain the fuel into a suitable container.
3. Wipe any fuel spillage from the engine.
4. Start the engine and let it run until it stops spontaneously after the remaining fuel has been consumed.



Do not carry out these activities near a source of fire and combustibles.



Do not connect any appliances to the power pack.

5. Unscrew the screws and remove the cover.
6. Drain the fuel from the carburettor after loosening the drain screw on the carburettor float chamber
7. Turn the fuel tap control to the "OFF" position
8. Tighten the screws.
9. Replace the cover and tighten the screws.
10. When the engine has cooled down completely, switch the fuel tap control to the "OFF" position.

## 6.2 Engine

Do the following to protect the engine against corrosion.

1. Remove the spark plug. Pour about a tablespoon of SAE15W40 oil into the spark plug hole. Refit the spark plug. Pull on the hand starter so that the oil covers the cylinder walls.
2. Slowly pull on the hand starter handle until you feel resistance. Leave it in this position.
3. Clean the power pack and leave it in a dry, well-ventilated, covered place in an upright position.

## 7. Troubleshooting

### 7.1 The power plant does not produce energy

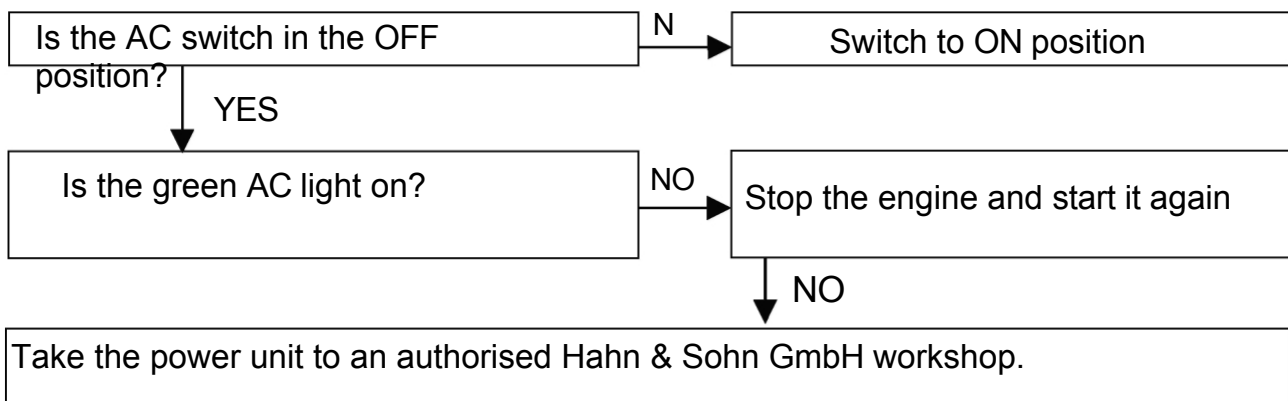

## 7.2 The power plant cannot be started.

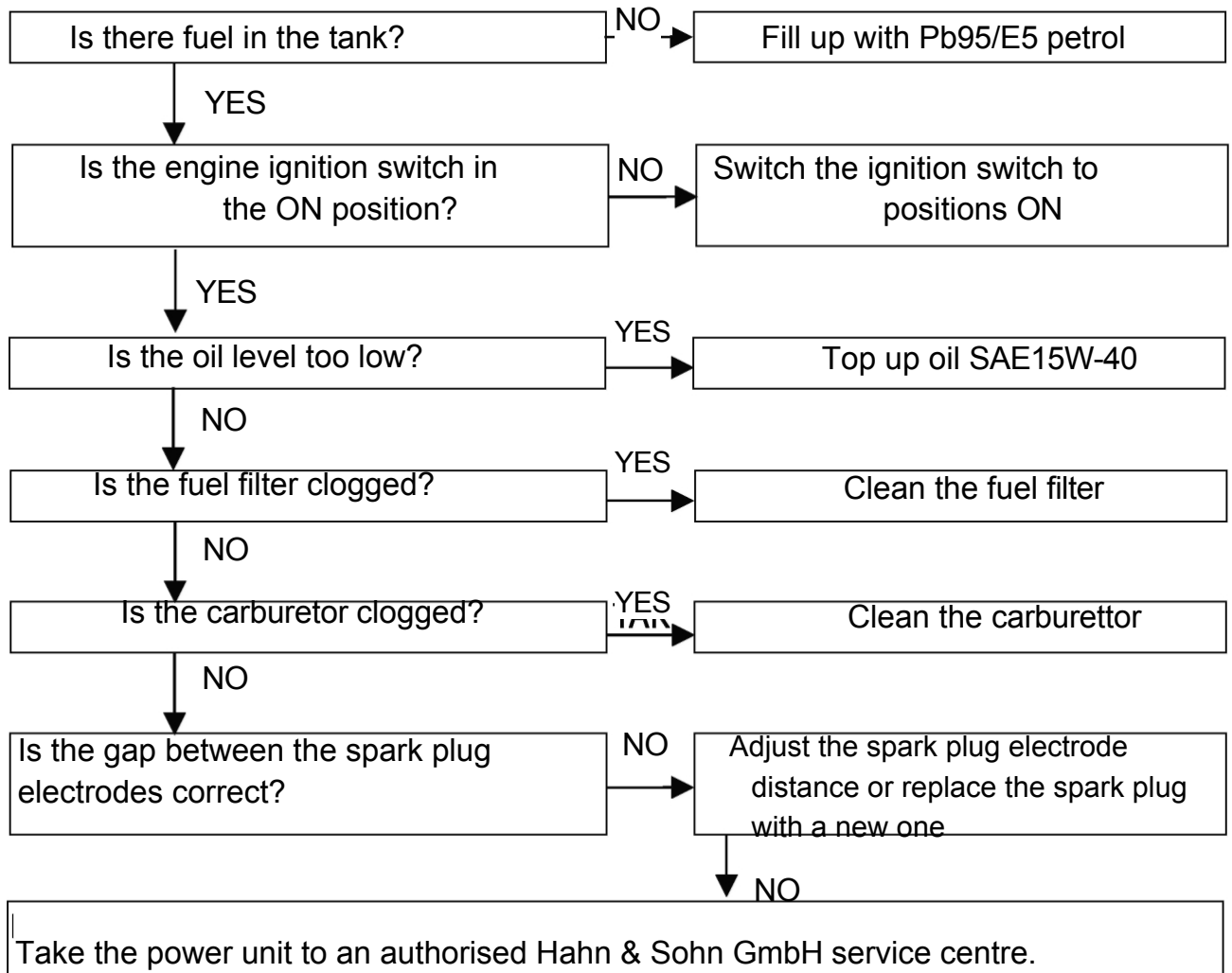



## 8. Technical data

Electro - headquart ers	Type		soundproof, inverter
	Frequency	Hz	50
	Voltage	V	230
	Rated power	W	700
	Effect		1
	Fuel tank volume	l	2,8
	Overload protection (DC)		NOT
Engine	Model		R56-I
	Type	1-cylinder, 4-stroke, spark-ignition, OHV, air-cooled	
	Stroke volume	cm <sup>3</sup>	56
	Fuel tank volume	l	0,28
	Spark plug model		A5RTC
	Starting		Manual
Physical parameters	dimensions (l x w x h)	mm	336x327x306
	Dry weight of the power plant	kg	12

u..m

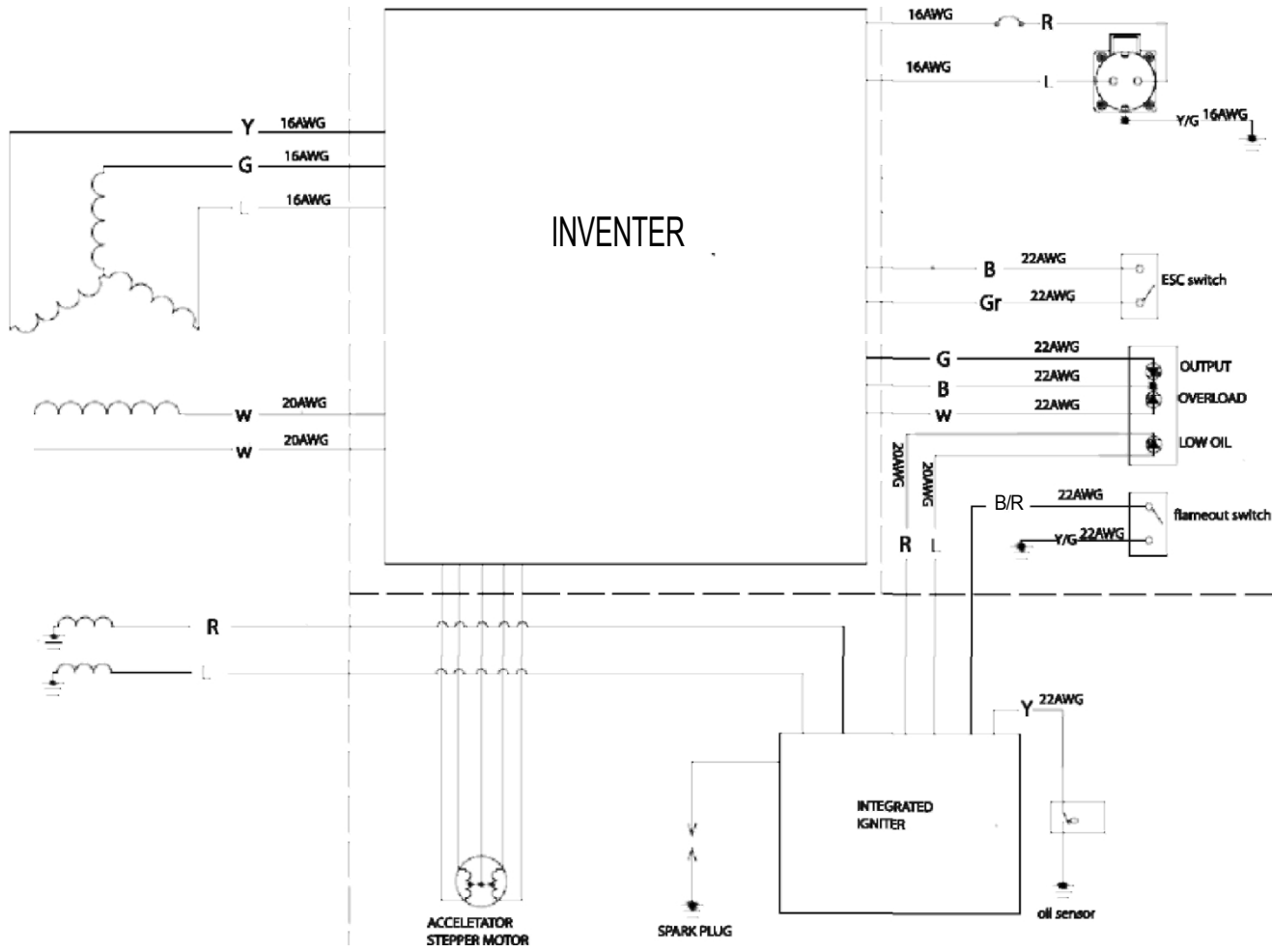

## 9. Electrical diagram

## 10. Declaration of conformity

### EC declaration of

Declaration of conformity  
number:  
**01/105755/2022**



Updated on:  
**25/01/2022**

Manufacturer:	Hahn & Sohn GmbH Auf der Schanze 20 93413 Cham
Notified person: Address of the notified person:	TÜV SUD Industrie Service GmbH Westendstraße 199, 80686 München Germany 0036

Device type **Electric power**

Model/Type: **plant H IG700**

Measured sound power level:	92.9 dB/A
Guaranteed sound power level:	95 dB/A

*Hahn & Sohn GmbH, Auf der Schanze 20 93413 Cham declares on its own responsibility that the equipment to which this declaration relates meets the requirements of the German Code of Laws:*

- no. 263 Coll. pos. 2202 of 21.12.2005
- No. 199 Coll. pos. 1228 of 21.10.2008
- No. 2016 Coll. pos. 806 of 2.6.2016
- No. 2016 Coll. pos. 542 of 4.2016
- 2020 Coll. pos. 1339 of 04.08.2020
- Noise Emissions Directive 2000/14/EC, as amended by 2005/88/EC (conformity assessment according to Annex VI)
- Machinery Directive 2006/42/EC
- Low Voltage Directive 2014/35/EU
- Electromagnetic Compatibility Directive 2014/30/EU
- Exhaust Emissions Directive 2016/1628/EU

*Thanks to the above compliance, the products have  
been put into circulation on the European  
Union market*

Person authorised to prepare and  
produce technical documentation: **Ing. Richard Janovský**

*The EC Declaration of Conformity is no longer the equipment is modified, rebuilt or used  
in a manner contrary to the instructions for use.*

In Cham on 25.01.2022  
TECHNICKÉ DOKUMENTACE

Ing. Richard Janovský  
VEDOUČÍ ODDĚLENÍ  
TECHNICKÉ DOKUMENTACE



## WARRANTY SHEET

The equipment is subject to warranty if purchased from Hahn & Sohn GmbH or an Authorised Regional of Hahn & Sohn GmbH. The warranty for 12 months or 500 motor hours from the time of purchase. The warranty applies exclusively to manufacturing and material defects. The warranty does not include:

- *mechanical damage due to improper operation,*
- *Repairs not carried out professionally or repairs carried out non-original spare parts,*
- *damage due to the use of unsuitable oils and fuels,*
- *such as: oils, filters, belts, batteries, etc.*

In the event of equipment failure, it must be delivered to the place of purchase or to the Service Centre. The cost of transporting the equipment to the place of purchase or to the Service Centre shall be borne by the Customer. If you have any questions, please contact:

**Service centre of the provider: Hahn & Sohn  
GmbH**

**Auf der Schanze 20**

**93413 Cham**

Tel. +490 9944 890 9 896

Mob. +490 163 02 44 737

E-Mail [info@hahn-profis.de](mailto:info@hahn-profis.de)

Web [www.hahn-profis.de](http://www.hahn-profis.de)

Regular inspections and checks are a condition of the warranty, including:

- engine oil and air filter changes as recommended by the Warrantor,
- oil checks and top-ups daily or max. every 8 hours of operation,
- oil and air filter change after 20 hours of operation, but no later than 6 months from the date of purchase. Others within the warranty period every 100 hours, but no later than 6 months from the date of the last service recorded in the Warrantor's authorized service network.

The warranty provider reserves the right to refuse a claim in the event that oils other than mineral SAE 20W40 are used during the warranty period. Documentation of the above inspections, including a record of oil types, service stamp, must be made in the "Inspections, Adjustments, Checks" section of the Warrantor's Operator's Manual or Service Manual each time.

Performing any repairs during the warranty period outside of an authorized service will void the warranty.

## **NO SILICONE OR OTHER ADDITIVES IN FUELS AND OILS!**

In the case of an accepted claim, the warranty is extended by the repair period. Claims without presentation of this warranty certificate including proof of purchase will not be accepted.

Our services and supplies do not include:

- installation, handover for use and training in the scope of operation and servicing of the equipment,

*The warranty provider undertakes to rectify the fault reported under warranty within 30 days from the date of delivery of the equipment.*

*Failure to collect the equipment from the warranty provider's service department within a period of more than three months from the date of notification of acceptance shall entitle the customer to storage charges.*

*The guarantee does not exclude, limit or suspend the rights of the buyer under the regulations on liability for defects in the sold item.*

.....

.....

.....

.....

### INSPECTIONS, ADJUSTMENTS AND CHECKS

INSPECTION AND ADJUSTMENT DESCRIPTION  REPAIRS SCOPE OF ACTIVITIES	NUMBER OF WORKS. HOURS	DATE   SIGNATURE OF THE SERVICE TECHNICIAN

### INSPECTIONS, ADJUSTMENTS AND CHECKS

INSPECTION AND ADJUSTMENT DESCRIPTION  REPAIR RANGE ACTIVITIES	NUMBER OF WORKS. HOURS	DATE  SIGNATURE SERVICE TECHNICIAN



**Central distributor and warranty provider Hahn &  
Sohn GmbH**

Auf der Schanze 20

93413 Cham

Tel: **+490 9944 890 9 896**

[www.hahn-power.de](http://www.hahn-power.de)

**Hahn a syn s.r.o. Lelkova  
186/4,**

**747 21 Kravaře**

[www.hahn-power.cz](http://www.hahn-power.cz)